

NAVIC™

National Vehicle Intelligence Cloud

A circular logo with a white background and a red border, containing the text "24/7" in a bold, black, sans-serif font. The "7" has a red diagonal slash through it. The logo is positioned on a red, angular graphic element that overlaps the background image of a control room.

24/7

Preparing your cell phone and PC

TRM001

Copyright Disclaimer

Has sole copyright of this learning material. Please be aware that this learning material and the supporting documentation is the intellectual property Of NAVIC. No part of this document may be reproduced or transmitted in any form or by any means without prior written permission from them Management of Navic.© NAVIC, All Rights Reserved. Training Manual.



#SaferCommunities

NAVIC™

National Vehicle Intelligence Cloud

Setup your cell phone and PC

Start by confirming that your phone date and time is set to automatic date and time in your phone settings. If future is not set to automatic on your cell phone you will not be able to log onto NAVIC cloud.

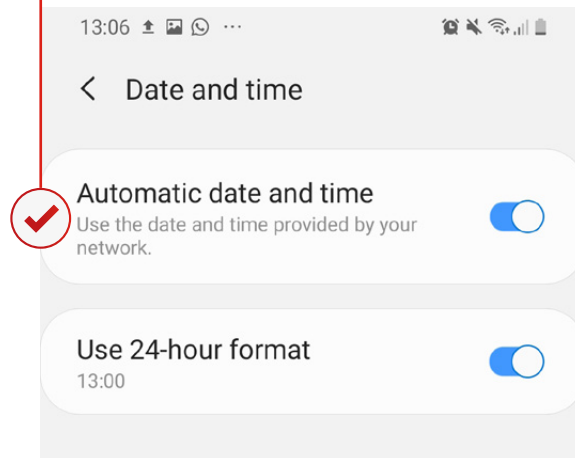

Type link in **CHROME** and install shortcut on home screen. You can ask the trainer to WhatsApp the link to you or go to <https://admin.navic.cloud/> Open link and save as an icon or bookmark on your smartphone / PC. Open link and save as an icon or bookmark on your smartphone / PC.

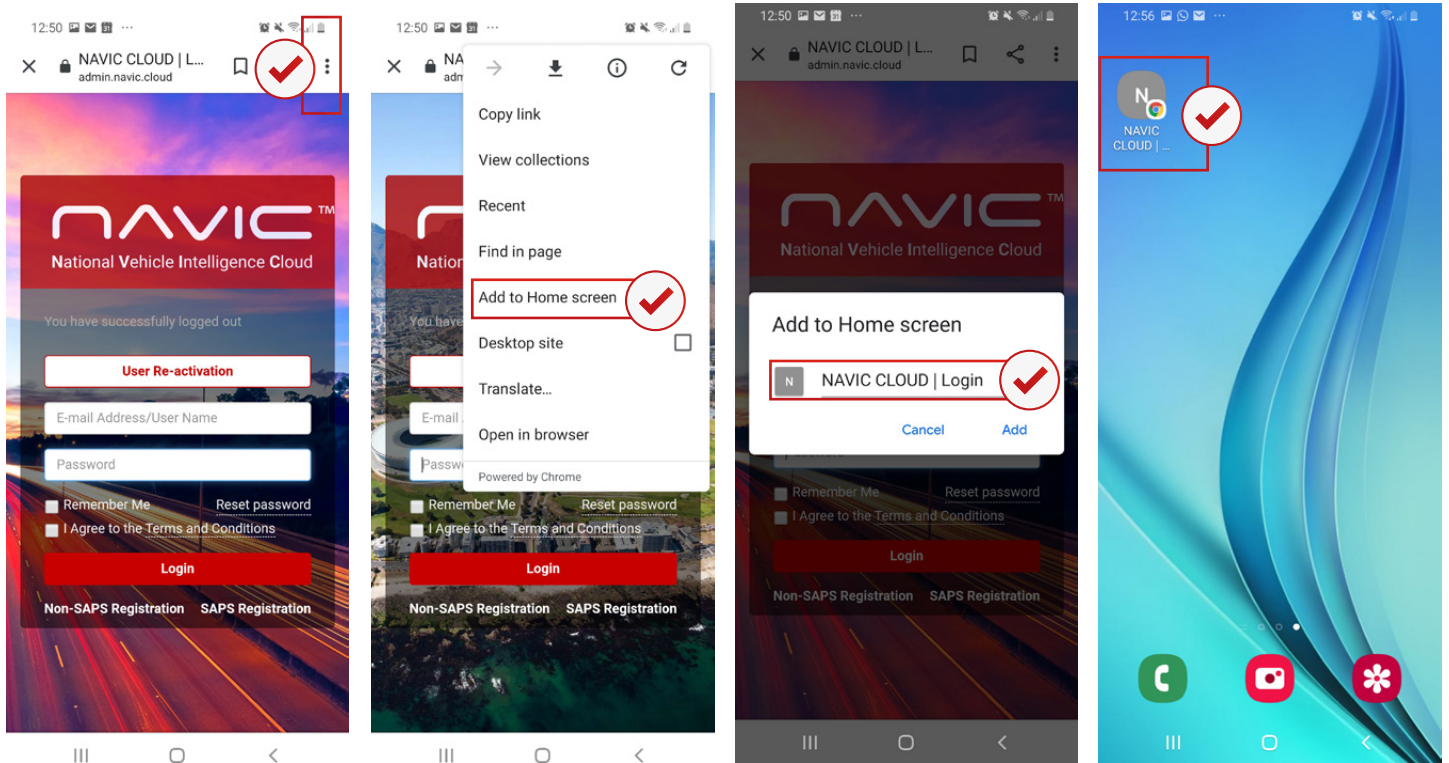

Click on and the drop down will appear. You can then select **ADD TO HOME SCREEN**. This will allow you to save a shortcut on your phone or PC. This process will differ between phone's. Principles stay the same.

Start the process of logging in

Download Google Authenticator

NAVIC has a security feature on the cloud to further secure our data in the case of lost / stolen devices. Please follow the instructions below. You will not be able to log in until this has been set up and completed.

- Download **GOOGLE AUTHENTICATOR** from App / Play store.
- Launch the application / open.

Add unique barcode linked to your NAVIC profile as user (as sent to you) /scan the barcode in on GOOGLE AUTHENTICATOR that will automatically start to supply a constant changing code every 30 seconds. Code will never be the same.

Every time you log in you will get a new number from AUTHENTICATOR – enter this into APPROVE CODE space.

If you have some trouble logging in with the code, go to settings and check “time correction for codes”.

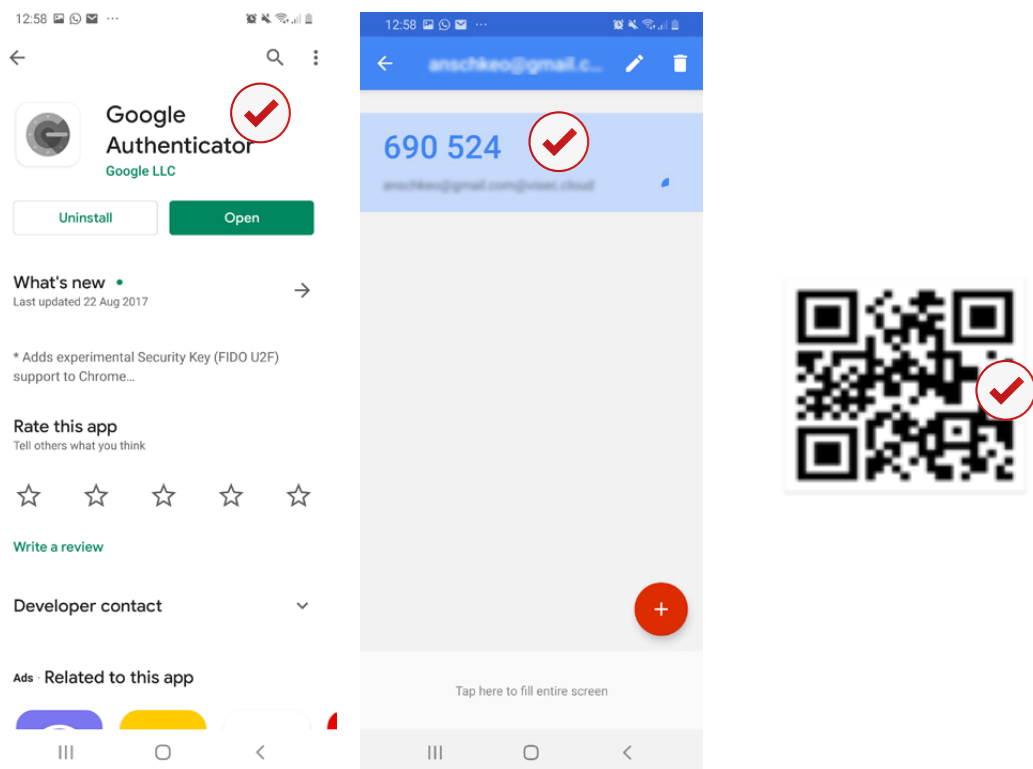

Click on icon to start. If you were previously a user of ANPR but not registered on the new cloud only complete the (**USER RE-ACTIVATION**). Any new 1st-time user must complete electronic application in full. Application for SAPS members and Non-SAPS members If you forgot your password follow instructions in **RESET PASSWORD**.

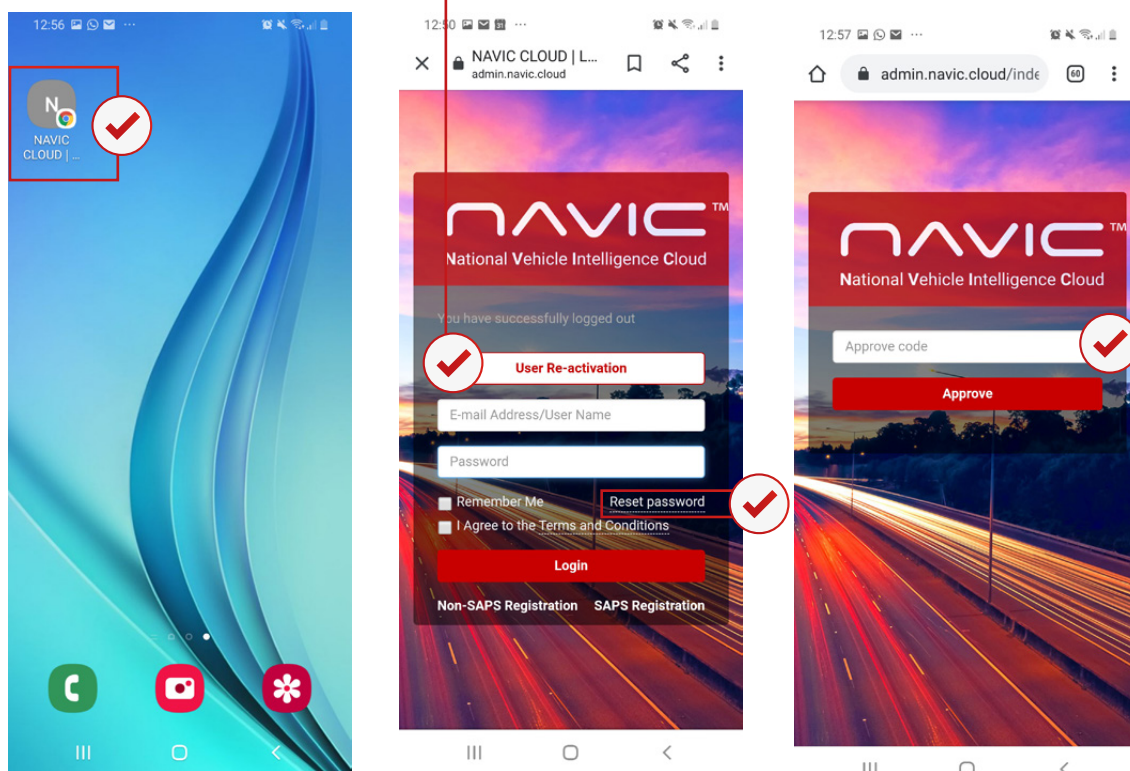

Steps to log in

- Log in with your e-mail address.
- Enter your password.
- Tick both boxes. (Each time you log in, you will need to mark at least **I agree.**)

The next screen will appear, and you will need **GOOGLE AUTHENTICATOR** to gain access to the system.

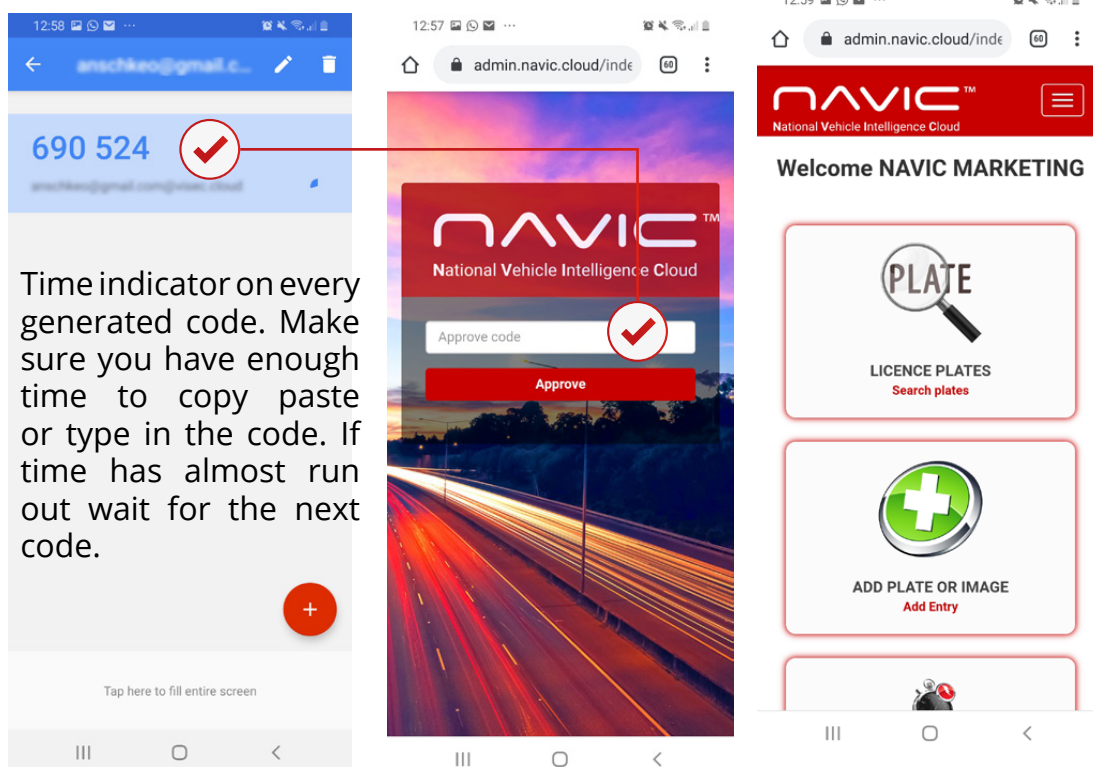

Time indicator on every generated code. Make sure you have enough time to copy paste or type in the code. If time has almost run out wait for the next code.

Successful login

When all steps are done correctly, your screen will appear as follows depending on your access level.

If you cannot log in and it says IP ADDRESS BLOCKED:

This is due to high security. Maybe you have tried a wrong password twice, or your device changed the IP address.

- Open a chrome / browser type in – whatismyip
- Take a screen shot and send to your trainer or e-mail to new_user@za.navic.cloud with a request to open your IP address again.

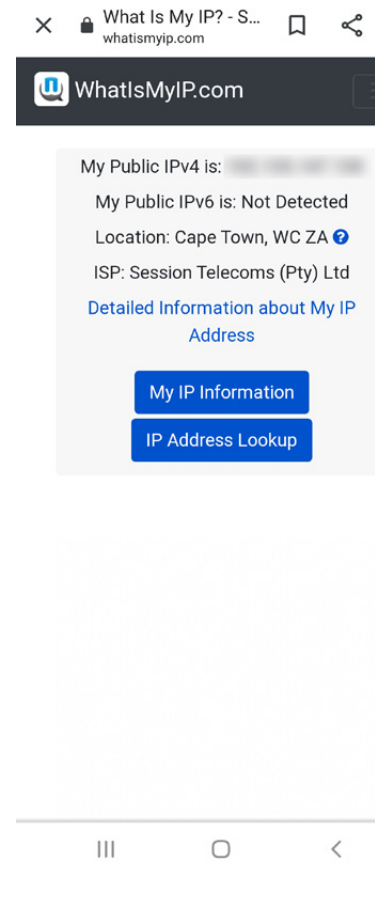
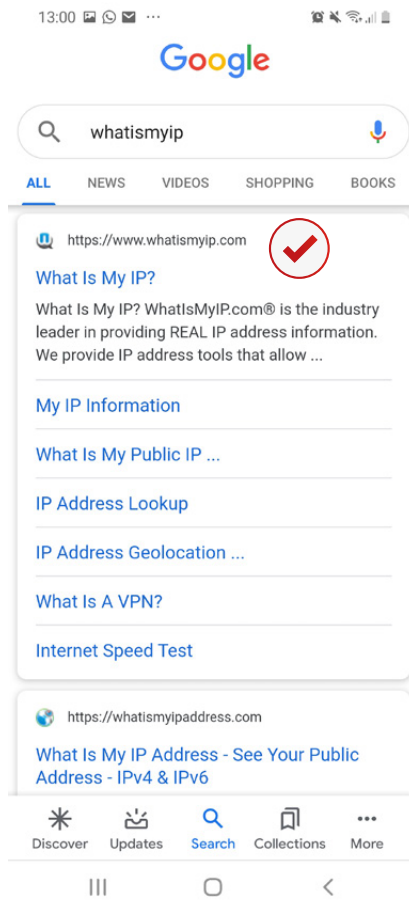
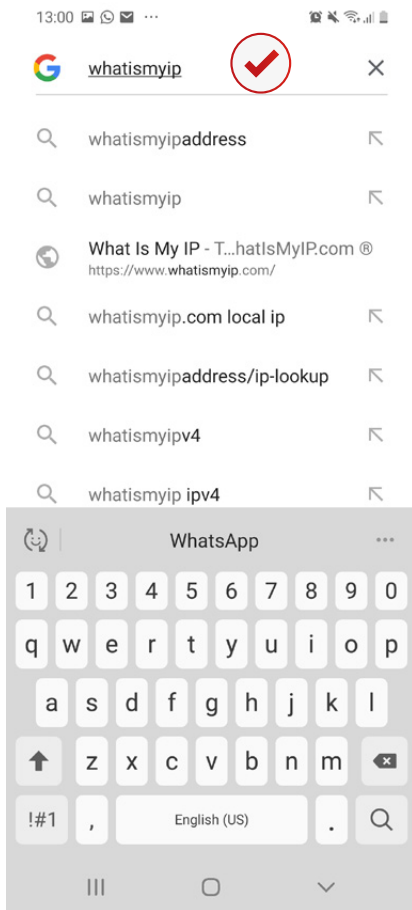

NAVIC™

National **V**ehicle **I**ntelligence **C**loud

© NAVIC, All Rights Reserved. Training Manual